

ZESPÓŁ ZABUDOWY MIESZKANIOWEJ WIELORODZINNEJ W SOKOŁOWIE PODLASKIM  
PRZY UL. GRUNWALDZKIEJ

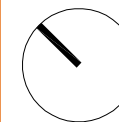







Inwestor: GRUNWALDZKIE OGRODY Tryboń PPI 4 Sp. z o.o., ul. Serocka 27 lok. 20, 04-333 Warszawa

Mieszkanie nr 8  
Parter

2PK



LEGENDA:

-  LOKAL
-  OGRÓDEK
-  POZOSTAŁE LOKALE
-  KOMÓRKA LOKATORSKA
-  WÓZKOWNIA
-  KOMUNIKACJA
-  WEJŚCIE DO LOKALU
-  WEJŚCIE DO POZOSTAŁYCH LOKALI

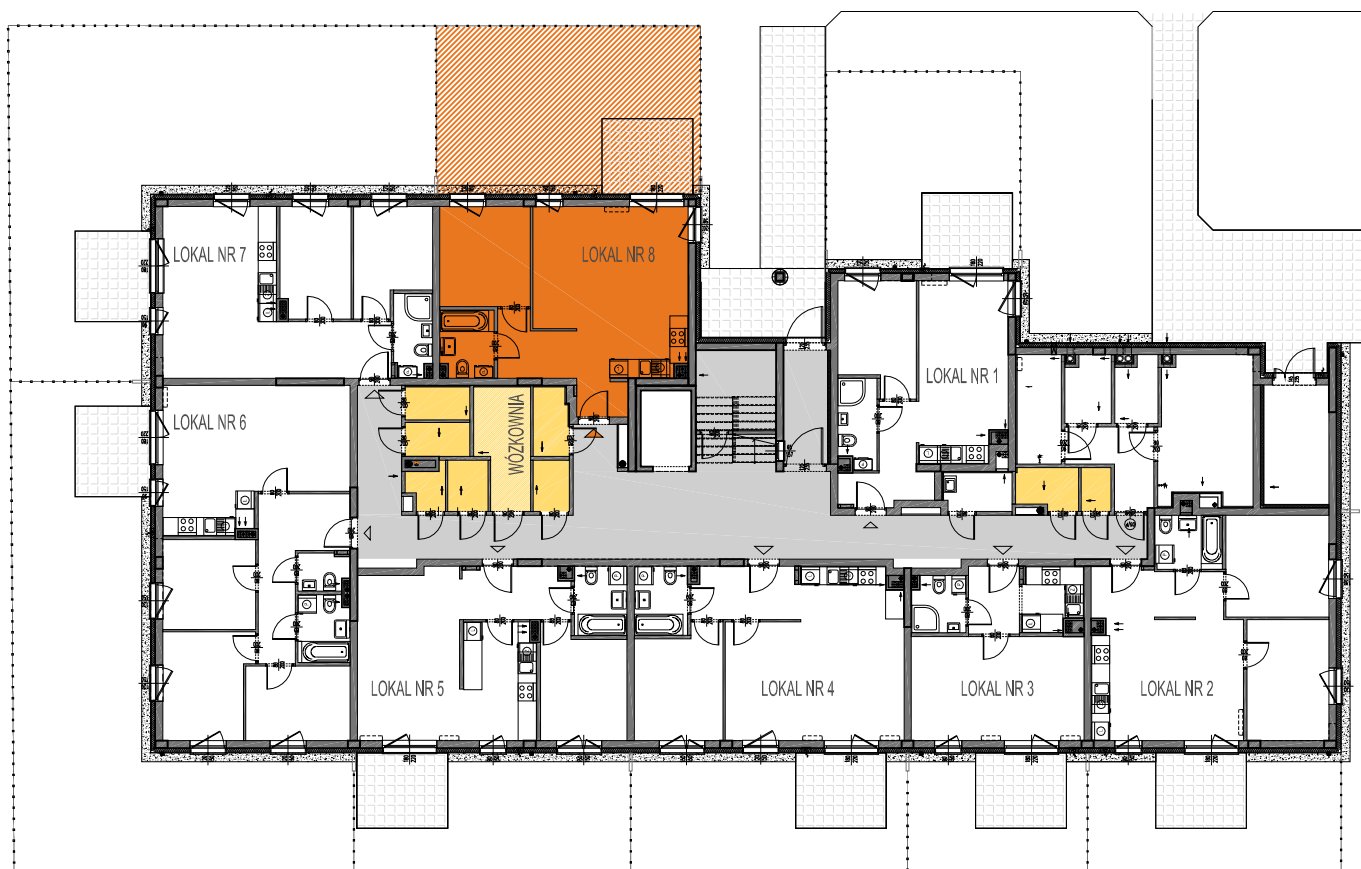

REALIZATOR

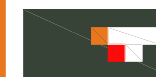

GRUNWALDZKIE OGRODY TPPI Sp. z o.o.  
04-333 Warszawa ul. Serocka 27 lok.20  
tel.: 22 509 65 55; fax: 22 509 65 00  
www.tppi.pl

PROJEKTANT



Grupa AT Sp. z o.o.  
04-333 Warszawa ul. Serocka 27 lok.3  
tel.: 22 509 65 85; fax: 22 509 65 65

SKALA 1:250